

## ES362 Series Racks – Equipment and cable access

Example cabinet: 12-2110 CANFORD ES3626626/B-L RACK CABINET 26U, 600w, 600d, black



Front view of cabinet when unpacked. Access via front door handle, (red circle).

Keys to lock/unlock front door, side panels and back panel located within. Example here shows access to equipment rack strips with keys tied to such – see right.



View showing side panel. Use keys on lock, (red circle).



Panel can now be lifted and eased away from the frame.



Side Panel removed.

Picture showing mounting strip/equipment access from side panel



## ES362 Series Racks – Equipment and cable access



Picture showing back panel. Use keys on lock, (red circle).

Panel is hinged like a door, after unlocking the panel will swing open.



Picture showing access to rack strips/equipment with back panel open.

To further aid access back panel can be removed from rack. Top hinge is sprung, pull down to release back panel and lift from the bottom hinge pin.



Back panel removed from cabinet.

## ES362 Series Racks – Equipment and cable access

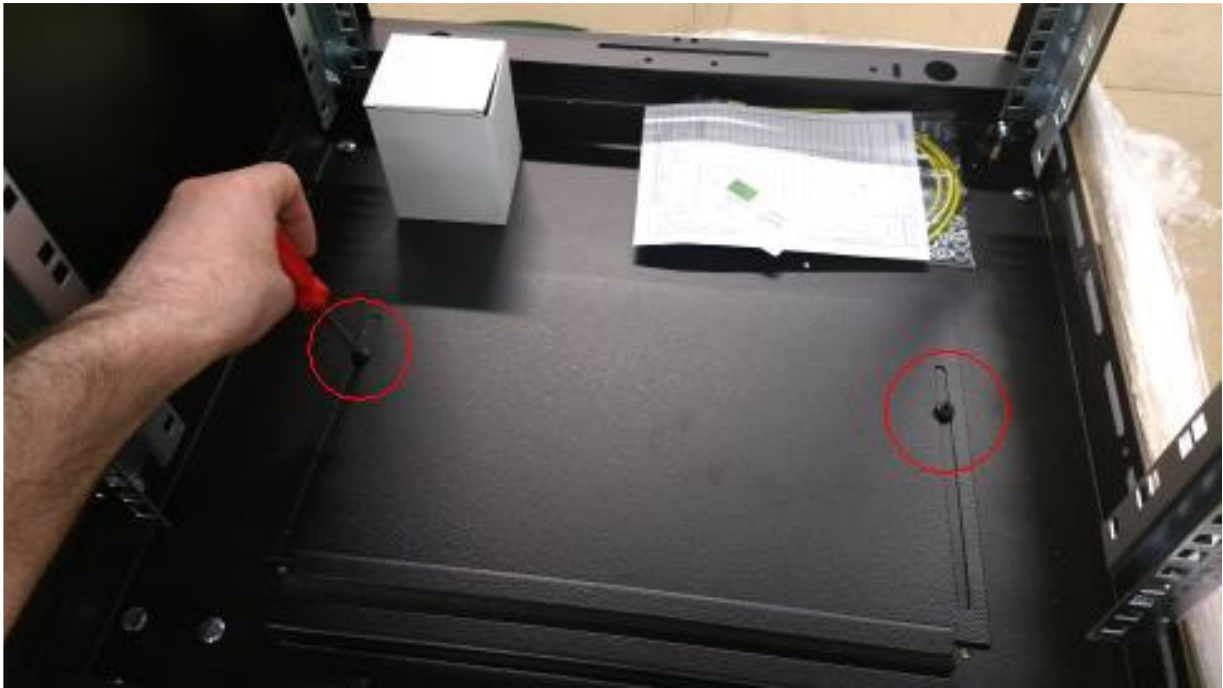

Picture showing bottom of rack and sliding access panel for cabling and services.  
Loosen the two screws to adjust panel gap required.

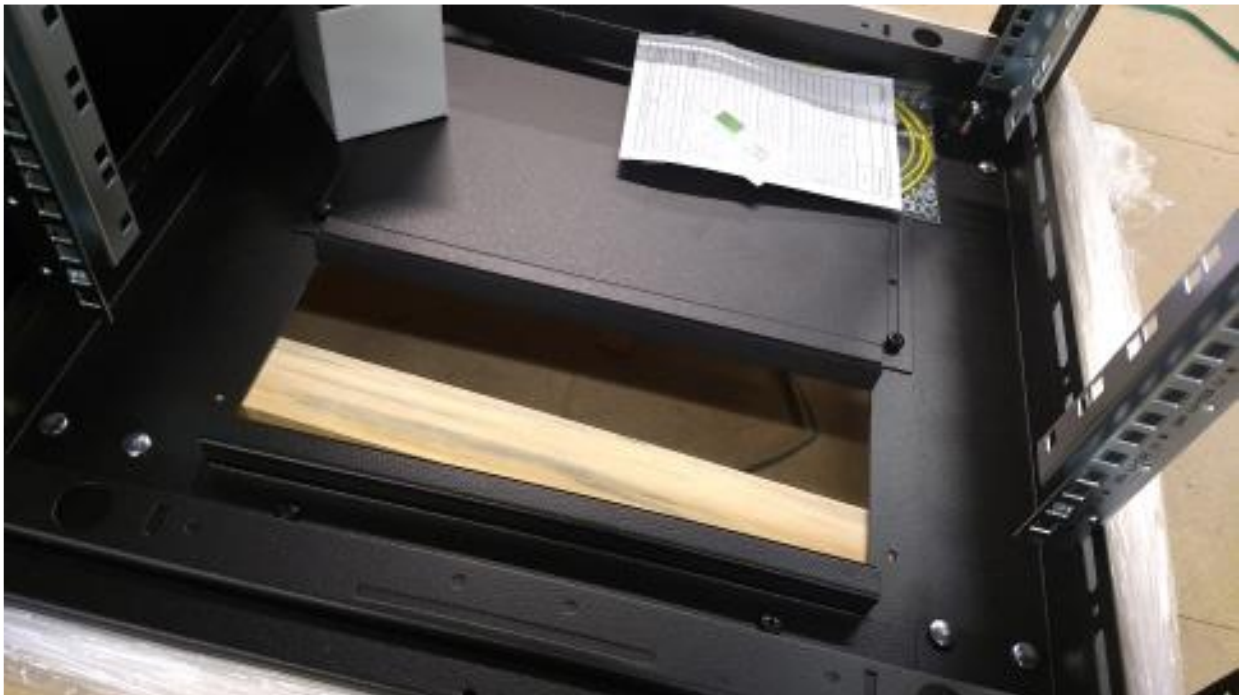

Bottom access panel fully open.