



SAFETY NOTICE

powerCON® TRUE1 TOP

Please regularly check the condition of your powerCON TRUE1 TOP connector system (cable connector & chassis) for clear signs of wear and tear.

Through improper use and the excessive use of force, the encoding lugs and guide slots in the connector system can become so severely worn or damaged that it is possible to insert the cable connector the wrong way. However, when inserted the wrong way, the cable connector should not twist-lock into place.

A cable connector/plug connector inserted the wrong way could, in some circumstances, lead to contact between live wires and the grounding contact in the plug socket.

To determine that the cable connector/plug connector is inserted correctly, follow the use instructions and listen for the "click" when performing the twist-lock. Immediately unplug any connector that does not twist-lock correctly in place.



Note:
When connecting, match the notch on the cable connector to the corresponding guide slot on the chassis.

Note:
After inserting properly as in illustration **A**, twist the cable connector clockwise to lock.

Note:
The proper twist-lock is achieved when the silvery tab is in the position shown in **C** and an audible «click» is heard.



SAFETY WARNING

incorrect insertion may cause electrical contact misalignment resulting in equipment malfunction and/or personal injury.

NEUTRIK AG	LI	T: +423 / 237 24 24	F: +423/232 53 93	NEUTRIK France	FR	T: +33 1/4131 6750	F: +33 1/4131 0511
NEUTRIK USA Inc.	USA	T: +1 704 / 972 3050	F: +1 704/438 9202	NEUTRIK Tokyo Ltd.	JP	T: +81 3/3663 4733	F: +81 3/3663 4796
NEUTRIK (UK) Ltd.	UK	T: +44 1983 / 811 441	F: +44 1983/811 439	NEUTRIK Hong Kong Ltd.	HK	T: +852/2687 6055	F: +852/2687 6052
NEUTRIK Vertriebs GmbH	DE/NL/AT/DK	T: +49 8131 / 280 890	F: +49 8131/280 830	NEUTRIK India Pvt. Ltd.	IND	T: +91/982 05 43 424	F: +91/22 26163 540

Draft. Nr.: BDA 559 | Update: 15.11.2018 | Data subject to change without prior notice. © 2018 NEUTRIK®. NEUTRIK® are registered trademark of NEUTRI AG. ALL RIGHTS RESERVED.



SAFETY NOTICE

powerCON® TRUE1 TOP

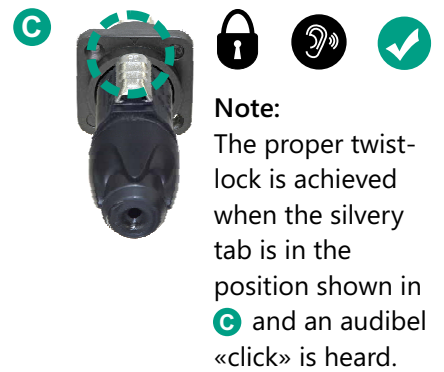
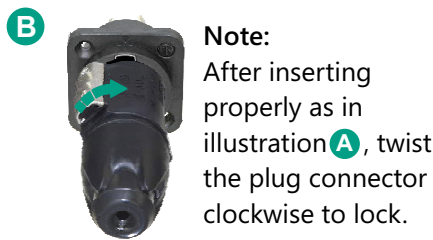
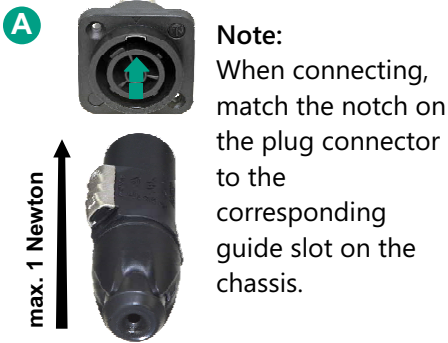



SAFETY WARNING

incorrect insertion may cause electrical contact misalignment resulting in equipment malfunction and/or personal injury.

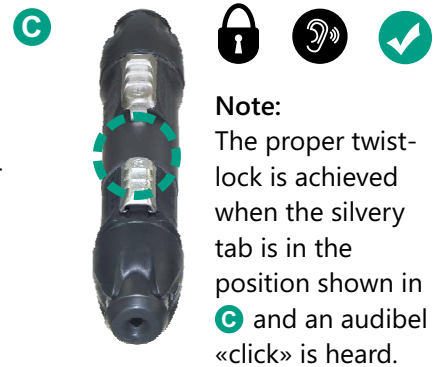
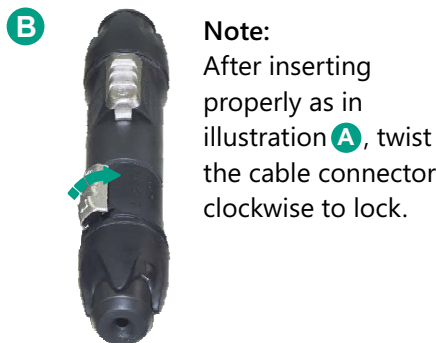
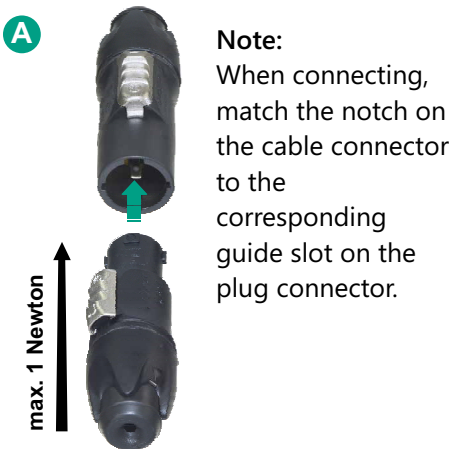



SAFETY WARNING

incorrect insertion may cause electrical contact misalignment resulting in equipment malfunction and/or personal injury.

NEUTRIK AG LI T: +423/237 24 24 F: +423/232 53 93
NEUTRIK USA Inc. USA T: +1 704/972 3050 F: +1 704/438 9202
NEUTRIK (UK) Ltd. UK T: +44 1983/811 441 F: +44 1983/811 439
NEUTRIK Vertriebs GmbH DE/NL/AT/DK T: +49 8131/280 890 F: +49 8131/280 830

NEUTRIK France FR T: +33 1/4131 6750 F: +33 1/4131 0511
NEUTRIK Tokyo Ltd. JP T: +81 3/3663 4733 F: +81 3/3663 4796
NEUTRIK Hong Kong Ltd. HK T: +852/2687 6055 F: +852/2687 6052
NEUTRIK India Pvt. Ltd. IND T: +91/982 05 43 424 F: +91/22 26163 540

Draft. Nr.: BDA 559 | Update: 15.11.2018 | Data subject to change without prior notice. © 2018 NEUTRIK®. NEUTRIK® are registered trademark of NEUTRI AG. ALL RIGHTS RESERVED.